

09/08/09

See Sheet 1-A For Index of Sheets

STATE OF NORTH CAROLINA  
DIVISION OF HIGHWAYS

**CALDWELL & WATAUGA COUNTIES**

LOCATION: US 321 FROM SR 1500 (BLACKBERRY ROAD)  
TO US 221 AT BLOWING ROCK

TYPE OF WORK: GRADING, DRAINAGE, PAVING, CULVERT, RETAINING WALLS,  
AND SIGNALS

STATE	STATE PROJECT REFERENCE NO.	SHEET NO.	TOTAL SHEETS
N.C.	R-2237C	1	
STATE PROJ. NO.	F.A. PROJ. NO.	DESCRIPTION	
34402.1.1		PE	
34402.2.6		R/W	
34402.3.7		CONST.	

**TIP PROJECT: R-2237C**

**CONTRACT: C202585**

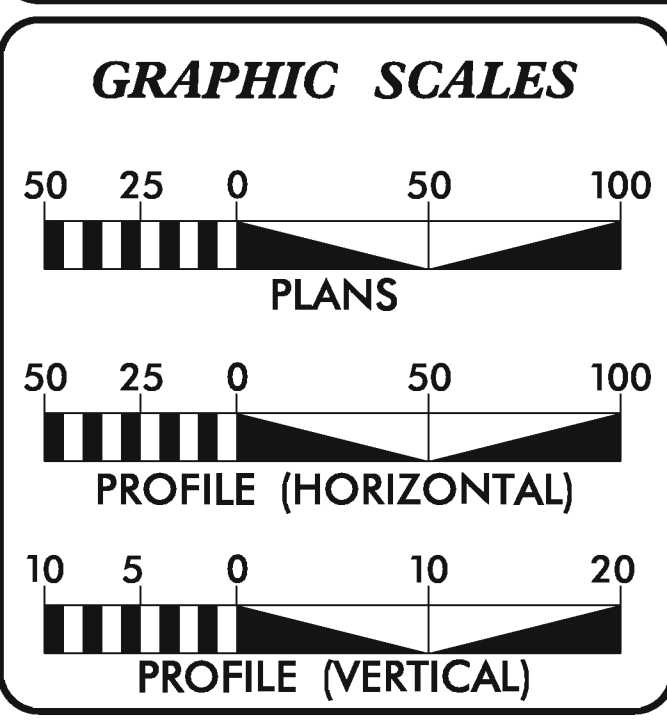
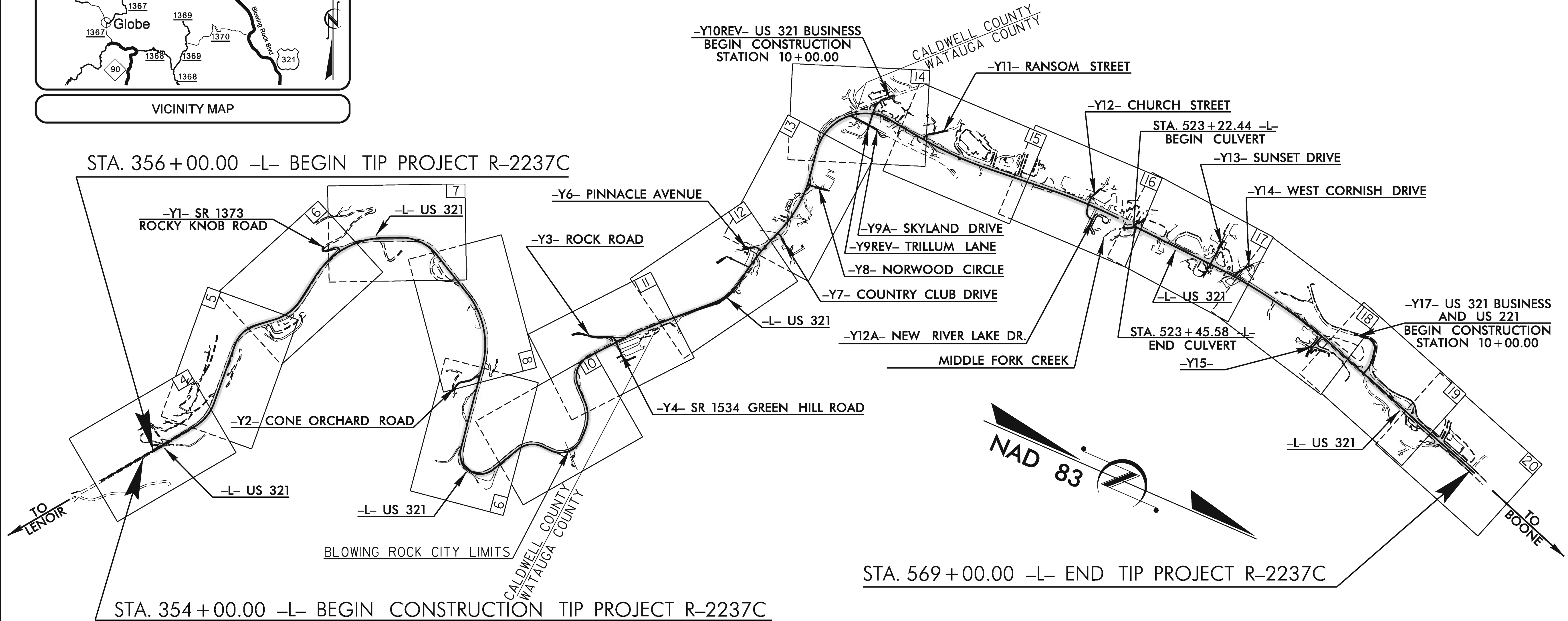
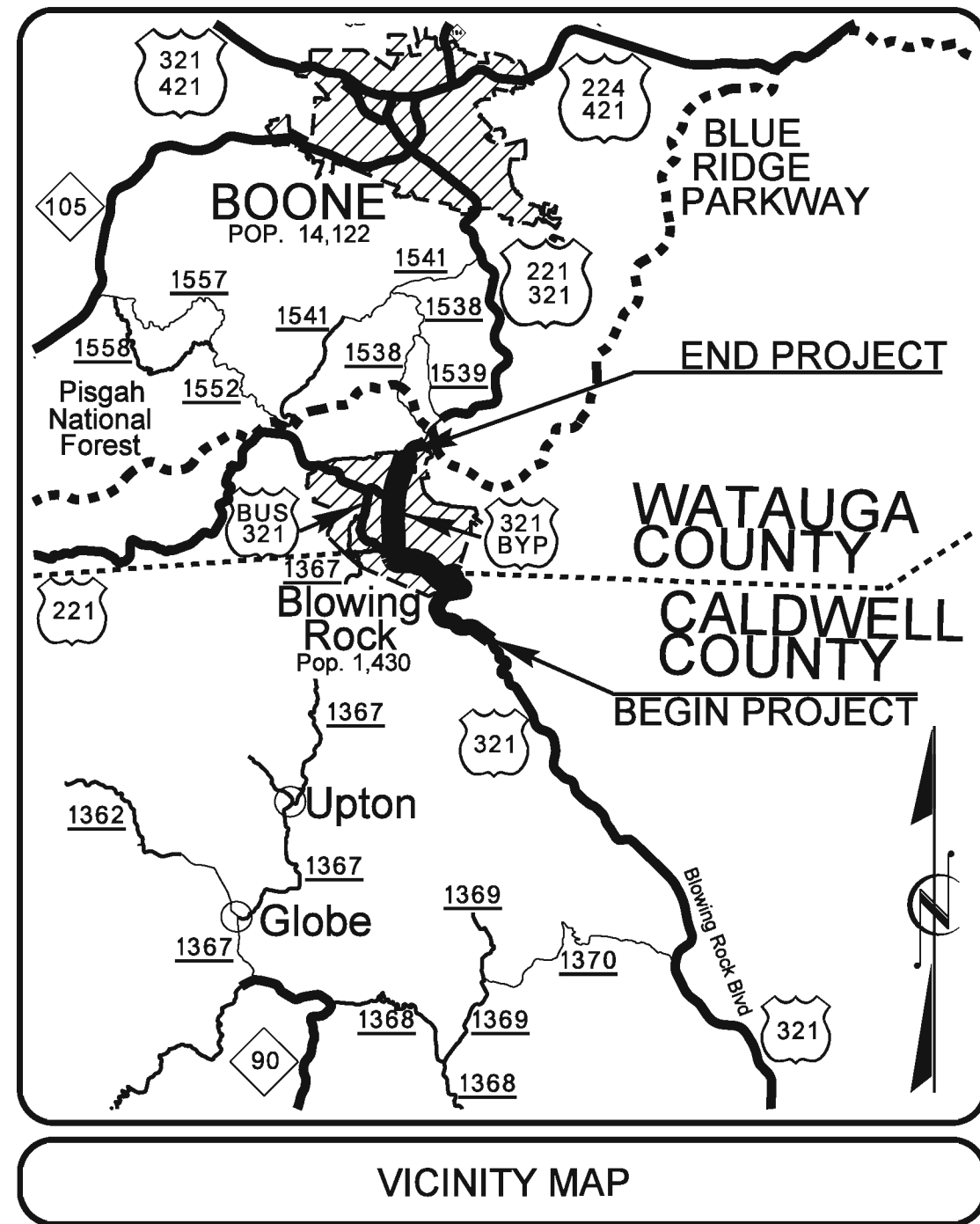

**DESIGN DATA**

ADT 2011 =	17,052
ADT 2035 =	23,100
DHV =	12 %
D =	55 %
T =	9 % *
V =	40 MPH
* TTST 3% + DUAL 6%	
STATEWIDE TIER	
FUNCTIONAL CLASSIFICATION	
ARTERIAL	

**PROJECT LENGTH**

LENGTH ROADWAY TIP PROJECT R-2237C	=	4.029 MILES
LENGTH STRUCTURE TIP PROJECT R-2237C	=	0.005 MILES
TOTAL LENGTH OF TIP PROJECT R-2237C	=	4.034 MILES

Prepared In the Office of:

**DIVISION OF HIGHWAYS**  
1000 Birch Ridge Dr., Raleigh NC, 27610

2006 STANDARD SPECIFICATIONS

<b>RIGHT OF WAY DATE:</b> JUNE 27, 2008	<b>G. E. BREW, PE</b> PROJECT ENGINEER
<b>LETTING DATE:</b> SEPTEMBER 20, 2011	<b>W. T. BEST</b> PROJECT DESIGN ENGINEER

**HYDRAULICS ENGINEER**

SIGNATURE: \_\_\_\_\_ P.E.

**ROADWAY DESIGN ENGINEER**

SIGNATURE: \_\_\_\_\_ P.E.

**DIVISION OF HIGHWAYS**  
STATE OF NORTH CAROLINA

STATE HIGHWAY DESIGN ENGINEER

15-AUG-2011 09:04 R:\Roadway\proj\11r2237c\_rdy-tsh.dgn \$\$\$USERNAME\$\$\$